



FLEETWOOD

DISCOVERY

Discovery

1 9 9 8







Discovery

Discovery



R real oak floor planks in the galley. Real porcelain sinks with Corian® countertops in the galley and bath. You can even opt for real leather furniture. Just about everything else is standard, though. Right down to the built-in Panasonic® VCR and the Sharp® convection carousel microwave oven. We would say the Discovery has all the comforts of home, but most homes don't offer this much comfort.

FLEETWOOD.



Solid wood drawers glide on nylon rollers and metal tracks. Even full-size dinner plates fit on cabinet shelves.

Wall panel with holding tank level meters, battery shutoff, plus controls for radio, water pump and more.



Our ceiling-ducted air conditioning cools every room evenly, even when it's 110° outside.

WHY YOU'LL SLEEP BETTER IN A FLEETWOOD RV.

We build our motor homes from the inside out so we can wire, plumb and assemble your RV with the quality and craftsmanship you expect in a new home. Since we're the world's largest motor home builder, our purchasing power lets us give you more coach for your dollar. Every roof, wall and floor is Vacubonded, our original process which ensures a flawless bond. For more strength and less weight, we use only steel or aircraft-grade aluminum frames. And with Fleetwood dealers across North America and a limited 1-year/3-year warranty, no wonder 1 out of 3 motor homes on the road is a Fleetwood.



inside
y is
means
or life.*

my.

The bedroom comes with its own 13" Panasonic® remote control color TV, standard. Its own audio system controls and speakers, standard. A designer mirrored rear wall, standard. Plantation blinds, picture windows and shirt wardrobes, all standard. And yes, that's a real, honest-to-goodness porcelain sink in the bathroom, standard. Obviously, the Discovery is not your standard motor home.

FLEETWOOD.



R real oak floor planks in the galley. Real porcelain sinks with Corian® countertops in the galley and bath. You can even opt for real leather furniture. Just about everything else is standard, though. Right down to the built-in Panasonic® VCR and the Sharp® convection carousel microwave oven. We would say the Discovery has all the comforts of home, but most homes don't offer this much comfort.

FLSETWOOD.

*Solid wood
on nylon
tracks. And
plates fit*



Heavy duty gas struts help lift the bed and hold it up so it's easy to use the storage space beneath.

20" Panasonic® stereo TV with remote, VCR and AM/FM/cassette stereo audio system, all standard.



All the furniture inside every Discovery is Flexsteel®, which means it is guaranteed for life.*

*See dealer for warranty.

The bedroom comes with its own 13" Panasonic® remote control color TV, standard. Its own audio system controls and speakers, standard. A designer mirrored rear wall, standard. Plantation blinds, picture windows and shirt wardrobes, all standard. And yes, that's a real, honest-to-goodness porcelain sink in the bathroom, standard. Obviously, the Discovery is not your standard motor home.

FLEETWOOD.

We take a Freightliner® chassis with air ride suspension, Jacobs® exhaust brakes and a whopping 275hp Cummins diesel. Then we add our patented Power Platform™ foundation. Stronger and more durable than ordinary designs, it lets you pack more and enjoy a hushed, silky-smooth ride. All of which makes the Discovery a real find.

D I E S E L P U S H E R C H A S S I S

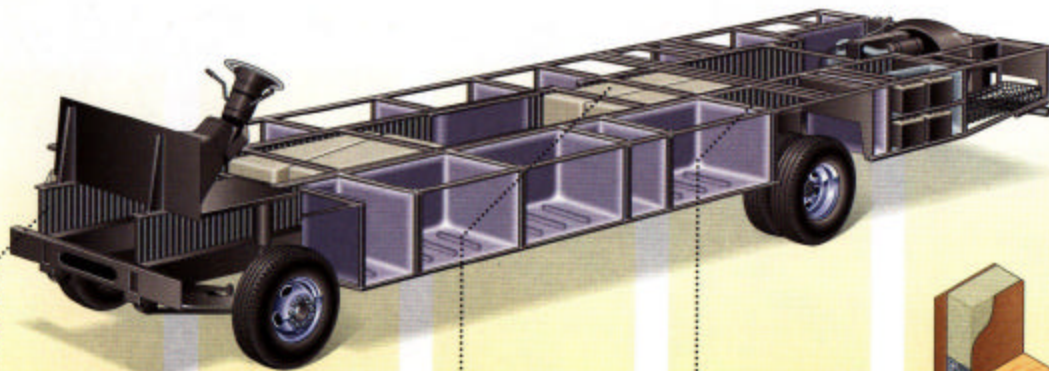

Steel I-beams are welded the length of the chassis for enormous weight-bearing ability.

A neoprene rubber gasket isolates the living area from the chassis for a quieter ride.

Water tanks run horizontally down the center of the frame for better balance.

Beefy steel outriggers firmly cradle all exterior compartments and add stability.

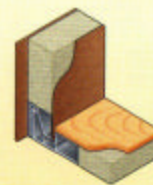

Interlocking aluminum extrusions grip the walls, floor, roof and chassis into one solid unit.

E - Z G

JUST ANOTHER EXAMPLE OF HOW OUR ENGINEERS EXTEND THEMSELVES

Stronger and 30% lighter than ordinary slide-outs, E-Z Glide™ uses up to 100% more weight-carrying capacity. There's nothing to jam. No pulleys to adjust. No stress on the sidewall, since the chassis supports the weight. No binding, because two guide blocks align the roof as it extends. No wonder. It's from Fleetwood RV.



SYSTEM



With an extra 31 square feet* in your living area, you can really stretch out and relax.



The EZ Glide® slide-out system offers extra peace of mind with its key-lock safety operation.

FLEETWOOD.



DISCOVERY EXTERIOR FEATURES

With its high-gloss, one-piece fiberglass outer walls, the Discovery reflects pride and sophistication from every angle. Our insulated, lighted, pass-through storage is perfect for longer items like skis. The crowned roof is covered with seamless rubber to shed water. And an exterior wash station helps keep dirt and sand outside.

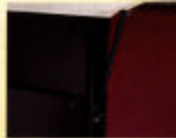

Gas struts and paddle latches let you open storage compartment doors with just one hand.

Every opening and edge on our walls, floor and ceiling are double-sealed against moisture.

Entry door and all compartments are keyed alike for convenience and better security.

The full fiberglass front cap sports a huge wraparound windshield for a sweeping view.

Drop-down hood for easy access to batteries, fluid level reservoirs and electrical panel.

*Exact square footage varies by model.

- Opt1 table w/chairs
- Galley/living room slide-out
- Swivel recliner
- Island queen bed
- Opt1 side-by-side refrigerator

MODEL
34Q



- Island queen bed
- Opt1 door-side sofa bed
- Opt1 table w/chairs
- Private toilet
- Opt1 side-by-side refrigerator

MODEL
36A



1998 DISCOVERY COLORS



Sun-washed Sage

Porcelain Beige

Sienna Burgundy

All of our fabrics have to pass color fastness tests as well as the Wyzenbeek abrasion test, the toughest standard in the textile industry, to help ensure years of beautiful use. Our nylon carpeting is textured to look newer longer.



- Opt'l door-side sofa bed
- Galley/living room slide-out
- Opt'l side-by-side refrigerator
- Island queen bed
- Opt'l table w/chairs

MODEL
36T



- Opt'l table w/chairs
- Galley/living room slide-out
- Swivel recliner
- Island queen bed
- Opt'l side-by-side refrigerator

MODEL
34Q



1998 DISCOVERY SPECIFICATIONS

Freightliner Chassis	36A	340	36R	36
Cummins Diesel Engine	275 hp	275 hp	275 hp	275
Wheelbase	228"	208"	228"	228
GWR lbs ¹	24,850	24,850	24,850	24,850
GCWR lbs ²	29,850	29,850	29,850	29,850
GAWR (front) lbs ³	9,350	9,350	9,350	9,350
GAWR (rear) lbs ³ (incl. tag)	15,500	15,500	15,500	15,500
Base Weight	18,640	18,700	18,650	19,400

Dimensions	36A	340	36R	36
Length	36' 10"	34' 7"	36' 10"	36' 10"
Height	12' 9/16"	12' 9/16"	12' 9/16"	12' 9/16"
Overall Width	102"	102"	102"	102"
Interior Height	79"	79"	79"	79"
Interior Width	96"	96"	96"	96"

Liquid Capacities (gallons)	36A	340	36R	36
Fresh Water Holding	80	80	80	80
Water Heater with Auto Ignition	6	6	6	6
Black Water Holding	60	40	60	60
Grey Water Holding	60	60	60	60
Appliance LPG Tank*	25	25	25	25
Generator LPG Tank*	40	40	40	40
Fuel Tank	90	90	90	90

Appliances, Standard Equipment

3-burner Range w/22" Oven	20" Stereo TV w/Interlock	8-cu. ft. Refrigerator
Bedroom & Galley Road Switching	.7-cu. ft. Eye-level Convection/Microwave	

Appliances, Options

	36A	340	36R	36
3-burner Cooktop	Opt	Opt	Opt	Opt
Washer/Dryer	Opt	N/A	Opt	Opt
Side-by-side Refrigerator w/ice maker	Opt	Opt	Opt	Opt

¹ GWR (Gross Vehicle Weight Rating): Maximum permissible weight of this motor home. The GWR is equal to or greater than the sum of the unloaded vehicle weight plus the net carrying capacity.

² GCWR (Gross Combination Weight Rating): Value specified by the motor home manufacturer as the maximum allowable loaded weight of this motor home with its towed trailer or towed vehicle.

³ GAWR (Gross Axle Weight Rating): Maximum permissible loaded weight a specific axle is designed to carry.

* Tank manufacturer's listed water capacity (WC) actual filled. LP capacity is 80% of listing due to safety shutoff required on tank.

- Island queen bed
- Large bedroom wardrobe
- Dual pantries
- Opt'l table w/chairs
- Swivel recliner

MODEL
36R



- Opt'l door-side sofa bed
- Galley/living room slide-out
- Opt'l side-by-side refrigerator
- Island queen bed
- Opt'l table w/chairs

MODEL
36T



1998 DISCOVERY FEATURES AND AVAILABLE EQUIPMENT

Exterior Automotive and Electrical, Standard Equipment

Wraparound Windshield	Single Motor Windshield Wiper System	
OEM Electronic Cruise Control	Hydraulic Levelers-Manual	Rear Vision Camera
Fiberglass Front/Rear Bumpers	Radial Tires-Michelin	Intermittent Wipers
Blend Auto A/C-Heating System	6.5kw Onan® Generator	Under-hood Utility Light
Large Automotive Halogen Headlamps	Stainless Steel Wheel Simulators	Mud Flaps
Radio Switch-Main or Auxiliary Battery	Dual 6-volt Battery-217-amp	Fog Lights
Trailer Hitch-5,000 lbs	Remote Heated Rearview Mirrors w/Indicator Lamp	
Patio Receptacle	Patio	

Interior Automotive, Standard Equipment

Residential Style Wainscot w/Paneling	D.S.I. Hot Water Heater	Water Filter
ECC Energy Climate Control	Water Heater By-pass	Auxiliary Start Circuit
3-way Water Pump Switching		

Exterior, Standard Equipment

Full Fiberglass Front Cap	Fiberglass Front Quarter Panels	Rubber Roof
One-piece Engine Access Door	Fiberglass Rear Wheel Trim	Large Viewing Windows
Dual Glazed Windows	Full Fiberglass Rear Cap	Awning Rail Molding
Power Step	Exterior Shower at Water Pump Compartment	
Roof Ladder	Black Powder-Coated Luggage Door Frames	
Luggage Compartment Lights	Aluminum/Vacubond Luggage Compartment Doors	
Roto-cast Luggage Compartments	Radius Entry Door w/Deadbolt Latch (keyed alike)	
Modular Generator Supports	Modular Entry Step Compartments	

Exterior, Options

	36A	34Q	36R	36T
Awning	21' 6"	21' 6"	21' 6"	21' 6"
Alcoa Aluminum Wheels	Opt	Opt	Opt	Opt

Safety, Standard Equipment

Smoke Detector	Carbon Monoxide Detector	Fire Extinguisher
LPG Detector	Emergency Exit Window	

Interior, Standard Equipment

Roller Guide Drawer Slides w/Ship Locks	Battery Disconnect	Brass Glass Shower Door
Large Residential Wood Drawers	Bright Brass & Chrome Door & Drawer Hardware	
Solid Wood Cabinet Doors & Drawer Faces	Skylight in Tub/Shower	Rear 15" TV w/Remote
TV Cabinet-Rear Bed	Molded Tub or Shower w/One-piece ABS Enclosure	
Large Slide-out Dinette Bins	Residential Grade Linoleum at Water Closet	
Plankwood Flooring at Galley	Wardrobe Lights	Wall-to-wall Carpet
Vinyl-wrapped Overhead Construction	Carpet Pad	2" Wood Blinds
Bedroom Wall Scones	Pillow Top Mattress	AM/FM Stereo
Headboard w/Decorative Mirrors	Telephone Jack	Fantastic Power Roof Vent
Upholstered Side Dinette Seats w/Carrel Back	Crown Molding-Bedroom	Power Bath Vent

Interior, Options

	36A	34Q	36R	36T
Dinette Table w/Freestanding Chairs	Opt	Opt	Opt	Opt
Power Driver Seat	Opt	Opt	Opt	Opt
Leather Power Driver Seat	Opt	Opt	Opt	Opt

Platform Construction and Body Structure, Standard Equipment

Aluminum & Composite Design	Box Vibration Isolators	Power Platform
Basement Configuration	Vacubond Floor	Paco Beam
Lightweight Hull Construction	Vertical Rear Wall	Steel Outriggers
Interlocking Aluminum Extrusions	Vacubond Walls w/H-Gloss Exterior Fiberglass	
Domed Roof w/Ducted A/C System	Heated Water & Holding Tank Compartments	
1000-watt Inverter/Converter	All Steel Undercarriage Modular LPG Tank Supports	

Sleeping Accommodations, Options

	36A	34Q	36R	36T
76" Leather Sofa Bed DS	Opt	N/A	N/A	N/A
52" Leather Sofa Bed DS	N/A	N/A	Opt	Opt
76" Leather Sofa Bed RS	Opt	Opt	Opt	Opt



A standard rear vision camera for a better view behind you.



Our optional washer/dryer makes short work of dirty laundry.



Standard climate control maintains a constant pre-set temperature.



New, high-efficiency dual roof A/C improves cooling yet uses 50% less power.

NO DIESEL HAS EVER CLIMBED LIKE THIS.

Launched in March 1996, the Discovery took off like a rocket and became the top-selling diesel motor home in its first year. Success fueled by a diesel that's everything you'd expect at a price you wouldn't.



CLASS A
DISCOVERY
DIESEL
MONTHLY
MARKET
SHARE



According to Statistical Surveys, Inc., Grand Rapids, MI.



Our auxiliary battery storage compartment is easily accessible.



Discovery's optional Alcoa® aluminum wheels are simply breathtaking.



Shower, soap dispenser, paper towel holder, in one compartment.



Discovery comes pre-wired for an optional Winegard® satellite dish.



YOUR TASTE HASN'T CHANGED. WE'VE JUST MADE IT AFFORDABLE.

You've always wanted a diesel motor home like the Discovery. A diesel pusher. Generous power. Gliding, air-ride suspension. Hushed, sumptuous accommodations. Vast storage. What you wouldn't give for something like that, right? Well, guess what. You don't have to give nearly as much as you thought. After all, the Discovery is built by Fleetwood RV, the world's top motor home maker. And we've always found ways for our customers to go farther.



Your local Fleetwood dealer is:

If no local dealer is indicated, write to the address below or call us toll free at 1-800-444-4905.
Or visit our Website at <http://www.fleetwood.com>

FLEETWOOD®

Fleetwood Enterprises, Inc.
PO Box 92919, Milwaukee, WI 53202-0919

Text and photography included in this brochure were as accurate as possible at the time of publication. Subsequent refinements in the actual product. Prices and specifications are subject to change without notice. All fuel and liquid capacities and dimensions are nominal. Fleetwood has designed its motor home brands to provide a variety of potential uses for its products. Fleetwood features the optimum storage, fluid, seating and sleeping capabilities. Though the customer enjoys this potential, it is the customer's responsibility to select the proper combinations of loads without exceeding the chassis weight capacities.

©Fleetwood Enterprises, Inc. Inventory Control No. 669801

Dear friend,

Here at Fleetwood RV, we have over 200 people working on research and development. But we get our best ideas when we hit the road in our motor homes.



Talking to people like you and noticing for ourselves little ways to make RVing more comfortable, more convenient and more fun.

If I had two pieces of free advice to give a friend in the market for a motor home, the first would be to get a Fleetwood RV. Not because we need to sell one more. Heck, we sell more than anyone else. But because I know we build the best product out there for the money.

Second, really think about your dealer. He has to be someone you trust for advice, service and accessories. Only the best get to be Fleetwood dealers in the first place. Then we work with them to continually improve customer satisfaction. That's why 9 out of 10 owners would recommend their Fleetwood RV to a friend and 9 out of 10 of them would also recommend their Fleetwood dealer.

I hope that helps. And I also hope I see you out there, somewhere in this beautiful world, enjoying your new Fleetwood RV while I'm out there doing the same.

John C. Crean

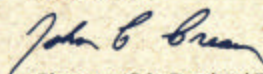

Chairman of the Board and Founder
Fleetwood Enterprises, Inc.

Your local Fleetwood dealer is:

If your local dealer is not indicated, write to the address below or call us toll free at 1-800-444-4905.
Or visit our Website at <http://www.fleetwood.com>

FLEETWOOD®

Fleetwood Enterprises, Inc.
PO Box 92919, Milwaukee, WI 53202-0919

Product information and photography included in this brochure were as accurate as possible at the time of publication. Subsequent refinements may be evident in the actual product. Prices and specifications are subject to change without notice. All fuel and liquid capacities are approximate and dimensions are nominal. Fleetwood has designed its motor home brands to provide a variety of potential uses for its customers. Each unit features the optimum storage, fluid, seating and sleeping capabilities. Though the customer enjoys this potential, he/she also has the responsibility to select the proper combinations of loads without exceeding the chassis weight capacities.

©Fleetwood Enterprises, Inc. Inventory Control No. 669801